

North Reading High School

Emergency Action Plan

Personnel involved in the emergency action plan include the athletic trainer, athletic director, coaching staff, and local Emergency Medical Technicians (EMTs). All personnel are encouraged to maintain CPR and First Aid certification. Emergency personnel will be taking on the following roles:

❖ **Emergency/acute care:**

- A certified athletic trainer (ATC) will activate the EAP
- If an ATC is not present, a member of the coaching staff or an administrator will assume the role of the first responder and will activate the EAP
- North Reading High School does not own a spine board; therefore, proper manual immobilization will be used for head/cervical trauma injuries by trained professionals until EMS arrives
- See maps below for locations of AEDs at each athletic venue
- Athletic Trainer should always have a portable AED on site

❖ **Contacting Emergency Medical Systems (EMS):**

- Any staff present, aside from the first responder monitoring the victim, will contact EMS for emergency transport
- The North Reading Fire Department has the closest location to North Reading High School and will therefore be contacted directly first
 - North Reading Fire Department: (978) 664-3112
 - The following information will be provided when calling EMS:
 - Name and phone number of the person calling
 - Address and specific location
 - Age, level of consciousness, and condition of the victim
 - First aid/treatment administered
 - Ask for an estimated time of arrival
- If athletic trainer is not on site, contact:
 - Igor Khuzeykin (Athletic Trainer)
 - (617) 771-1478
 - Dave Johnson (Athletic Director)
 - (781) 838-2025

❖ **Biohazard:**

- If biohazardous material present, such as blood, vomit, or other bodily fluids, a cleaning crew will be notified
- Stained clothing will be placed in separate bags and washed accordingly

❖ **Documentation:**

- Event must be documented and turned into athletic trainer, athletic director, and school nurse

Lightning Safety

In the event of a lightning storm during competition at any NRHS field, athletes, coaches, and staff will enter the locker rooms for the duration of the storm. Spectators will be encouraged to return to their vehicles with all windows and doors secured.



If an individual is still found outdoors during the lightning storm, they should find an open area of the field and assume the **Lightning Safety Position**.



NRHS Gymnasium

*AEDs are marked with a circle and a cross

**EMS will enter via Entrance to Main Street

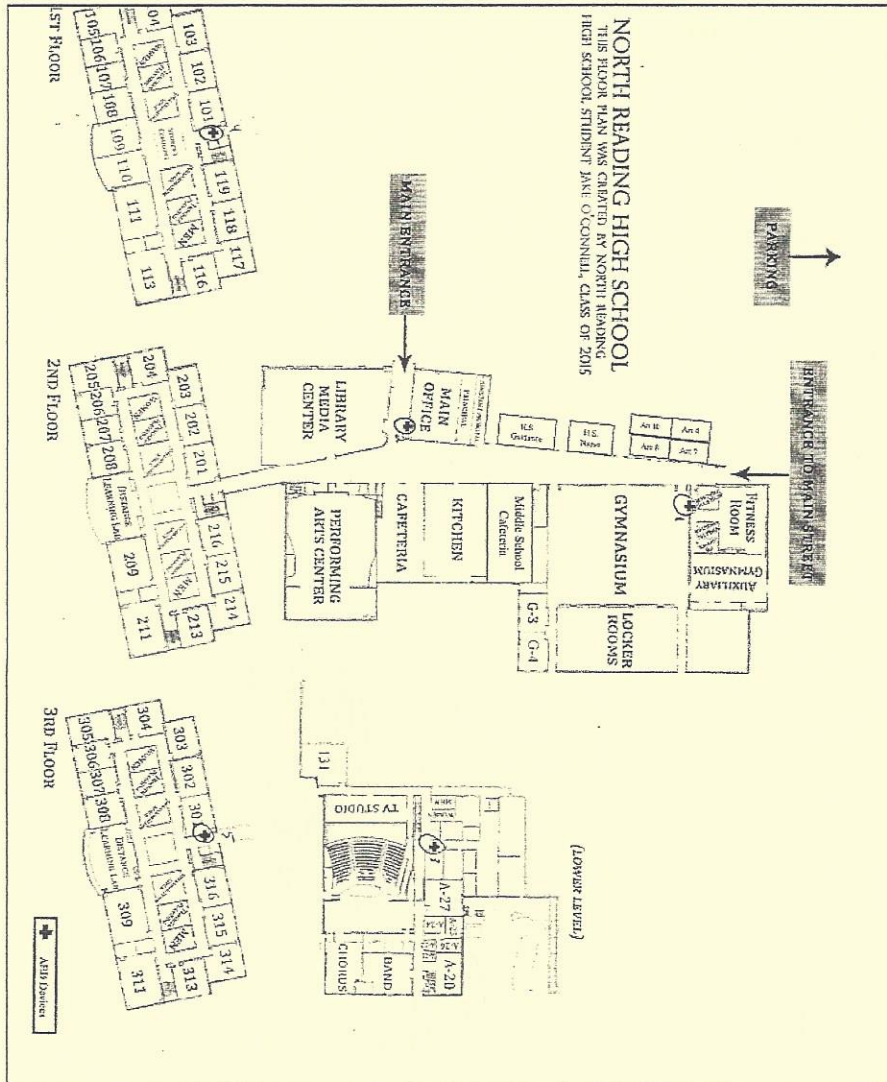

Auxiliary Gymnasium

*AEDs are marked with a circle and a cross

**EMS will enter via Entrance to Aux Gym

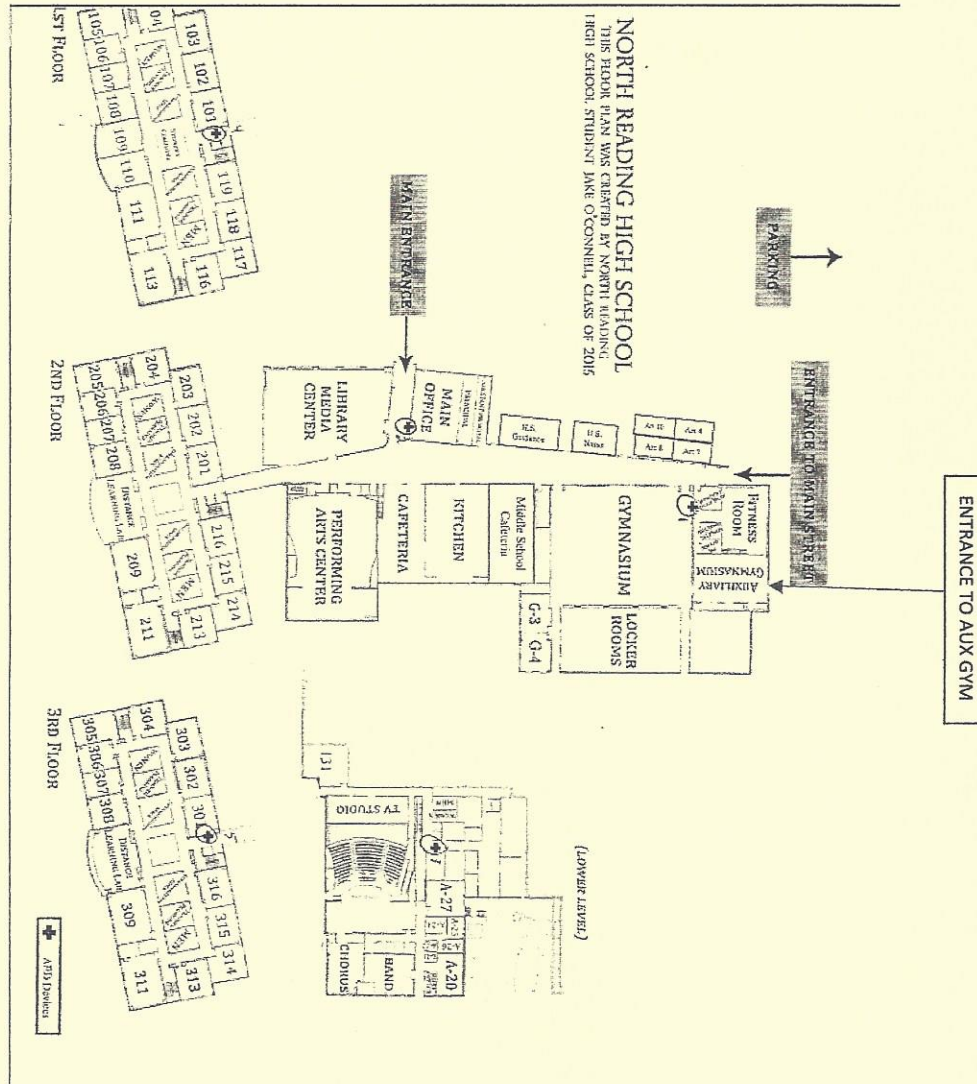

NRHS FOOTBALL FIELD

*AED marked with a yellow cross

**EMS will enter via Dodge Rd. entrance (Denoted by blue arrow)



Carey Park Field

*AED marked with a yellow cross

**EMS will enter via Batchelder School entrance (Denoted by blue arrow)

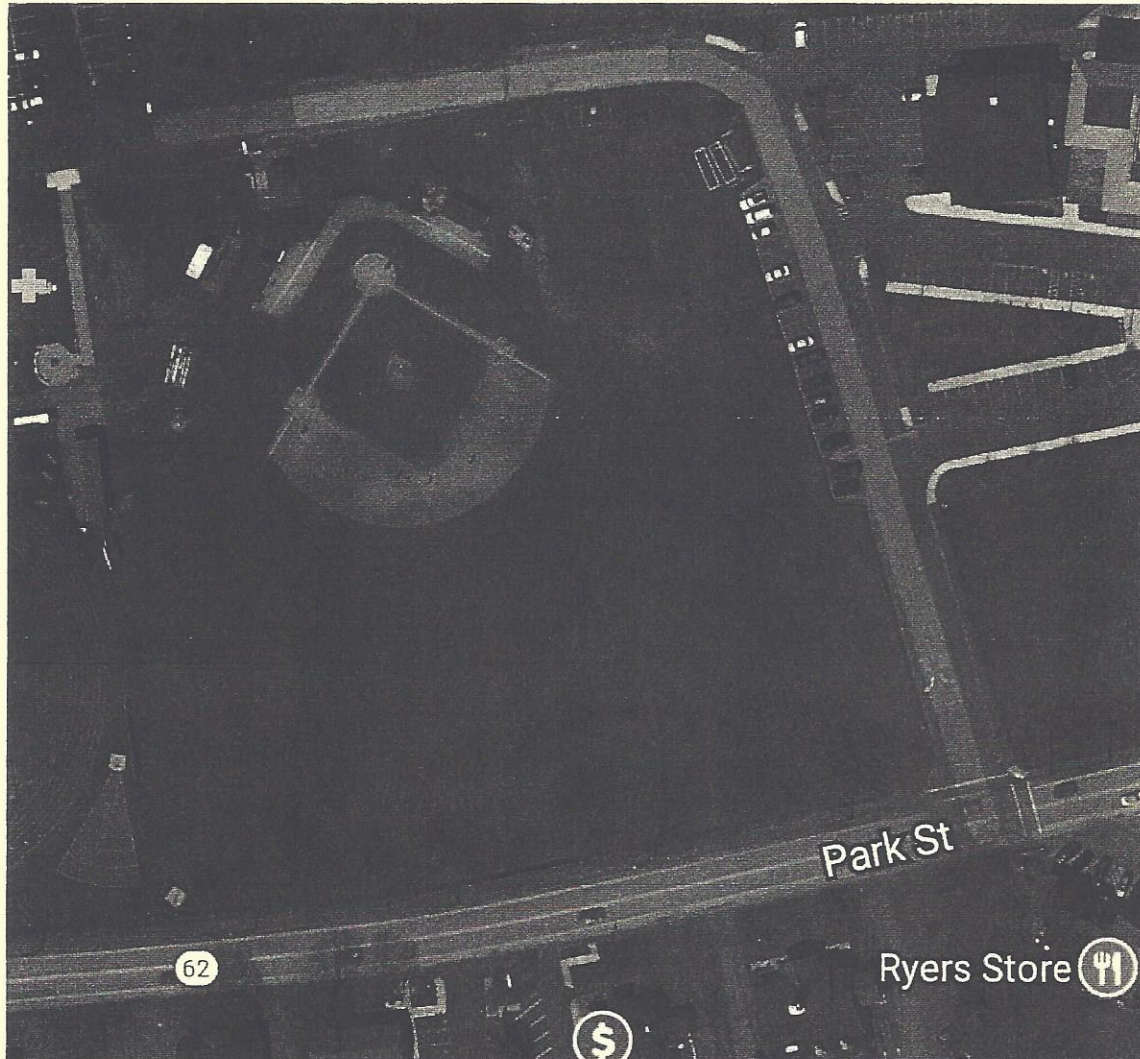

NRHS NEW GRASS FIELD

*AED marked with a yellow cross

**EMS will enter via lower parking lot (Denoted by blue arrow)

